

Curotto-Can Commercial Gripper

The **Curotto-Can**
The Future of Automated Collection



Leverage your investment in a commercial front loader by adding the cost-saving Curotto-Can Commercial Gripper system.

The Curotto-Can Commercial Gripper enables a commercial front loader to grab, lift, and empty 32- to 96-gallon wheeled carts using either outside- or inside-the-cab controls. It is specially designed to lift heavy carts, such as those filled with green waste, food waste, or recyclables like crushed glass.

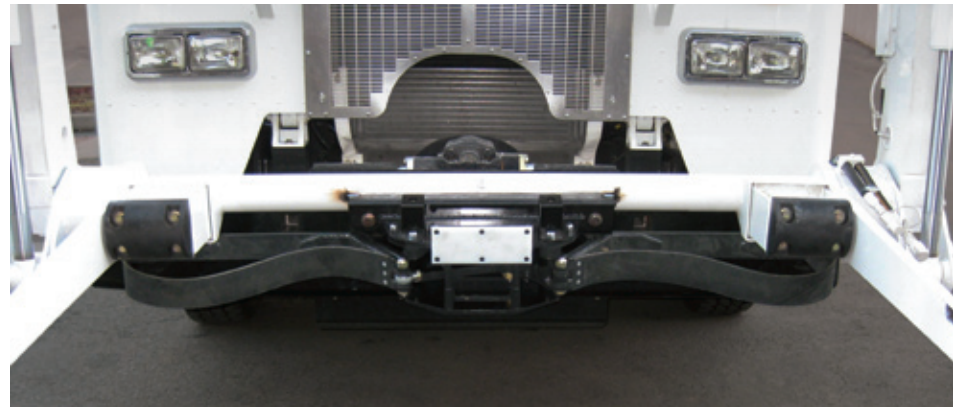

Key Features

- Eliminates the need for a second truck to pick up wheeled carts, which minimizes route duplication and reduces operating costs
- Provides the best gripper system for heavy carts without damaging cart bar pockets
- Positive lock system prevents carts from being lost in the hopper
- Mounted lower and forward on the fork tube to eliminate interference issues and protect the top of the packer blade and canopy from damage due to collision
- Route-proven technology means reliable performance
- Tucks out of the way when not in use to enable collection of commercial containers
- Patent pending

The Commercial Gripper can be ordered pre-installed on your front loader directly from the body manufacturer. For units already in service, a retro-fit installation kit is available.



**Environmental
Solutions Group**

A DOVER COMPANY

P R O D U C T S H E E T

Technical Specifications

| Dimensions | |
|--|---------------------------|
| Width | 76.50 inches |
| Height at Center | 10.75 inches |
| Depth at Center | 12.75 inches |
| Weight | 220 lbs. |
| Capacity | |
| Carts | 32 to 96 gallons, wheeled |
| Lift Capacity | 500 lbs. |
| Control System | |
| Inside or externally mounted curbside-accessible switch bank | |
| Hydraulic System | |
| Pressure | 2000 psi |
| Supply | 5 US gpm |
| Priority divider mounted to packer body. Flow divider is activated by container controls, not continuously activated. | |
| Cylinder | |
| Bore | 1.50 inches |
| Stroke | 7.00 inches |
| Shaft Diameter | 1.00 inches |
| Induction-hardened, ground, and polished chromed rods | |

Curotto-Can Commercial Gripper

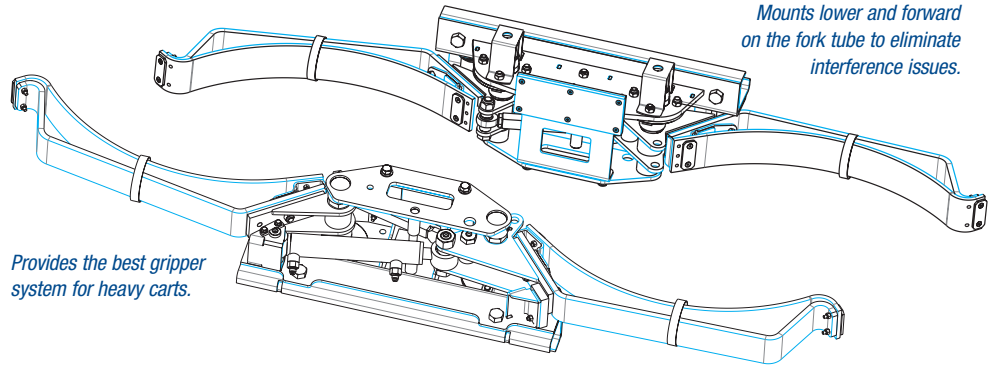

Mounts lower and forward on the fork tube to eliminate interference issues.

Provides the best gripper system for heavy carts.



Positive lock system prevents carts from being lost in the hopper.



Authorized Dealer:



The **Curotto-Can**
The Future of Automated Collection

The Curotto-Can, Inc.
2030 Hamilton Place Boulevard, Suite 200
Chattanooga, TN 37421
P: 707.939.2802 • F: 413.521.6644

© 2013 The Curotto-Can. All rights reserved. Curotto-Can is a registered trademark of The Curotto-Can Company. SWS-C00005-111513



**Environmental
Solutions Group**

A DOWER COMPANY

www.doveresg.com

